

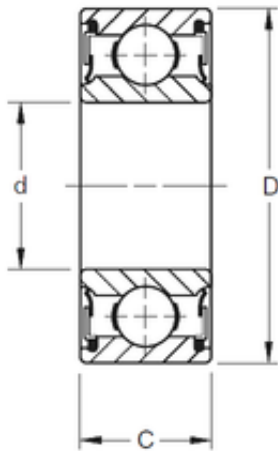

Shenzhen YUYING Bearing Co., Ltd.



25,4 mm x 50,8 mm x 9,52 mm TIMKEN S10PP2 Single Row Ball Bearings

Bearing No. S10PP2

Size	25.4x50.8x9.52 mm
Bore Diameter	25,4 mm
Outer Diameter	50,8 mm
Width	9,52 mm
d	25,4 mm
D	50,8 mm
B	9,52 mm
C	9,52 mm
Weight	0,082 Kg
Basic dynamic load rating (C)	11 kN

S10PP2 Bearing 2D drawings and 3D CAD models